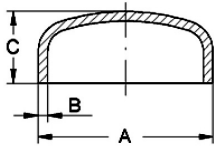

Fittings for welding DIN EN 10253-3
Art.No
EUR
Art.No
EUR
Bottom DIN 2617, convex

DN	A	B	C					AISI316Ti-1.4571	
15	21,3	2	9					537631	Enquiry
20	26,9	2	12					537632	12,70
25	33,7	3	15					537633	14,90
32	42,4	3	17					537634	18,30
40	48,3	3	21					537635	23,60
50	60,3	3	22					537636	26,50
65	76,1	3	29					537637	30,10
80	88,9	3	29					537638	48,20
100	114,3	3	32					537639	66,50
125	139,7	3	39					537641	76,40
150	168,3	3	51					537642	116,10
200	219,1	3	58					537644	160,20
250	273	3	61					537646	224,10
300	323,9	3	72					537648	260,70